

MOLD DATE & RECYCLING INSERTS

PCS Standard Date Stamps.....	F2
PCS Center Inserts.....	F3
PCS Double Date Stamp.....	F4

PCS Standard Date Stamps



- Includes body and center insert
- Center insert sits flush within body
- Designed for efficient installation and removal
- Stainless steel construction
- Provides excellent traceability

These date stamp assembly are made of stainless steel. The Center Insert is always at the same level as the body of the date stamp. Diameters ranging 4 mm to 20 mm are available. Center Inserts are easily changed reducing downtime.

MONTH	INSERT	DAY	SHIFT	YEAR	A	C	J	L
DS 0422-xx	DP 2275-xx		DS 04-03	DS 04-Y-xx	4	2.2	7.5	12
DS 0530-xx	DP 3075-xx	DS 05-31L	DS 05-03	DS 05-Y-xx	5	3.0	7.5	12
DS 0632-xx	DP 3217-xx	DS 06-31L	DS 06-03	DS 06-Y-xx	6	3.2	17.0	20
DS 0847-xx	DP 4717-xx	DS 08-31L	DS 08-03	DS 08-Y-xx	8	4.7	17.0	20
DS 1057-xx	DP 5717-xx	DS 10-31L	DS 10-03	DS 10-Y-xx	10	5.7	17.0	20
DS 1267-xx	DP 6717-xx	DS 12-31L	DS 12-03	DS 12-Y-xx	12	6.7	17.0	20
DS 1687-xx	DP 8717-xx	DS 16-31L	DS 16-03	DS 16-Y-xx	16	8.7	17.0	20
DS 20107-xx	DP 10717-xx	DS 20-31L	DS 20-03	DS 20-Y-xx	20	10.7	17.0	20

Note: Mold operating temperature should not exceed 150°C (300°F). When ordering add year to the end of the part number (i.e. DS 0632-18) or for assembly with arrow only (i.e. DS 0632)

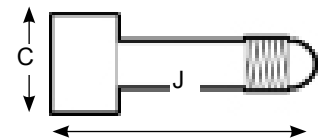

ENGRAVING DEPTH INCHES			
Size	Characters	Arrow Head	Arrow Body
3 mm	.004 - .008	.016 - .020	.016 - .020
4 - 5 mm	.004 - .006	.016 - .020	.016 - .022
6 mm	.004 - .008	.016 - .020	.016 - .020
8 mm	.006 - .010	.016 - .020	.016 - .020
10 - 16 mm	.008 - .012	.020 - .024	.020 - .024
20 mm	.008 - .012	.020 - .024	.020 - .024

CENTER INSERTS WITH ARROW & YEAR		
ITEM NO.	C	J
DP 2275-xx	2.2	7.5
DP 3075-xx	3.0	7.5
DP 3217-xx	3.2	17.0
DP 4717-xx	4.7	17.0
DP 5717-xx	5.7	17.0
DP 6717-xx	6.7	17.0
DP 8717-xx	8.7	17.0
DP 10717-xx	10.7	17.0

Note: When ordering add year to the end of the catalog number (i.e. DP 3217-18)

PCS Center Inserts



- Sits flush within body assembly
- Designed for efficient installation and removal
- Stainless steel construction
- Provides excellent traceability

This center insert has a stainless steel construction and is always at the same level as the body of the date stamp. Diameters ranging 4 mm to 20 mm are available. Center Inserts are easily changed reducing downtime.

SPECIFICATIONS	
Hardness	48 - 54 Rc
Material Type	INOX. 1.4034
Unit of Measure	Metric DIN

CH Series

Compact Height

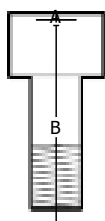

RF Series

Remains Flush

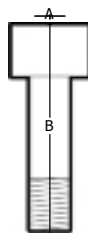

STANDARD Series

PCS Standard



ITEM NO.	A mm	B mm
DCP04-AO	2.2	8
DCP04-	2.2	8
DCP05-AO	3.1	8
DCP05-	3.1	8
DCP06-AO	3.1	8
DCP06-	3.1	8
DCP08-AO	4.4	10
DCP08-	4.4	10
DCP10-AO	5.2	12
DCP10-	5.2	12
DCP12-AO	6.2	14
DCP12-	6.2	14
DCP16-AO	8.2	14
DCP16-	8.2	14
DCP20-AO	11	16
DCP20-	11	16

ITEM NO.	A mm	B mm
DFP03-AO	1.6	9
DFP03-	1.6	9
DFP04-AO	2.5	10.5
DFP04-	2.5	10.5
DFP05-AO	3.1	13
DFP05-	3.1	13
DFP06-AO	3.1	13
DFP06-	3.1	13
DFP08-AO	4.6	14
DFP08-	4.6	14
DFP10-AO	4.6	14
DFP10-	4.6	14
DFP12-AO	6.4	17
DFP12-	6.4	17
DFP16-AO	8.4	23
DFP16-	8.4	23

ITEM NO.	A mm	B mm
DP 2275	2.2	7.5
DP 2275-	2.2	7.5
DP 3075	3.0	7.5
DP 3075-	3.0	7.5
DP 3217	3.2	17
DP 3217-	3.2	17
DP 4717	4.7	17
DP 4717-	4.7	17
DP 5717	5.7	17
DP 5717-	5.7	17
DP 6717	6.7	17
DP 6717-	6.7	17
DP 8717	8.7	17
DP 8717-	8.7	17
DP 10717	10.7	17
DP 10717-	10.7	17

Note: When ordering add the two digit year to the end of the catalog number (i.e. DCP04-18)

AO = Arrow Only

PCS Double Date Stamp

- Replaces the need for two separate date stamps
- Requires only one machined hole
- Stainless steel construction
- Provides excellent traceability



The Double Date Stamp replaces the need for two separate date stamps. With this unique feature, there is no need to machine two separate holes. The month and year on the Double Date Stamp is easily adjusted.

SPECIFICATIONS	
Hardness	48 - 54 Rc
Material Type	INOX. 1.4034
Unit of Measure	Metric DIN

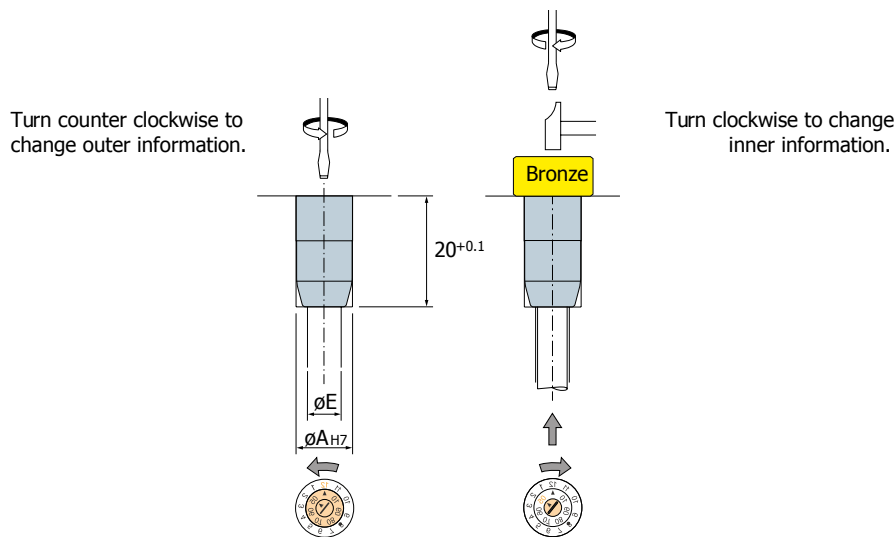
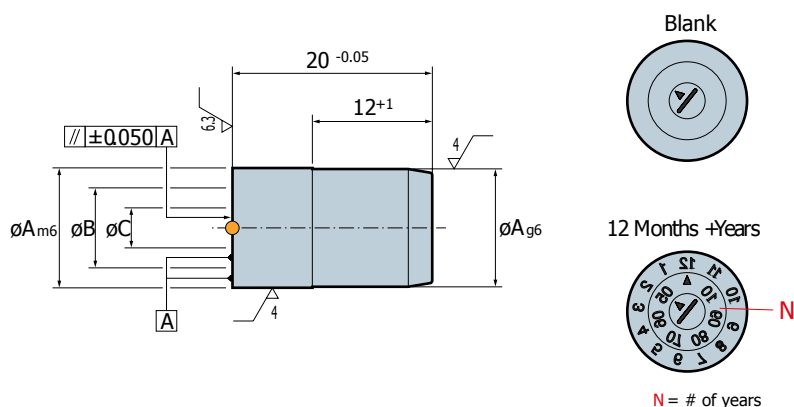

ITEM NO.	A	B	C	E	N
FD 080512-xx	8	5.5	3	6	5
FD 120812-xx	12	8	4	10	6
FD 161012-xx	16	10.5	5.3	12	10

Note: When ordering add the two digit year to the end of the catalog number (i.e. FD 120812-18)